



Smart Home System User Guide – iPhone iOS

Smart Home System User Guide – iPhone IOS Version

Chapter 1 Get started	P.3
Chapter 2 Mobile App installation	P.4 - P.7
Chapter 3 Register an account	P.8 - P.16
Chapter 4 Login and key interfaces introduction	
4.1 Confort interface	P.17
4.2 Automation interface	P.18
4.3 Security interface	P.19
4.4 Setting interface	P.20
Chapter 5 Other Functions	
5.1 Update gateway firmware	P.29 - P.30
5.2 Change time zone	P.31

Chapter 1 Get started

To get started, you will at least need:

- a Wi-Fi router that connects to the Internet, and know the SSID and password of the router
- a SEG-X3 gateway
- an iPhone smartphone

Follow these 2 simple steps to get started:

1. Insert the SEG-X3 gateway into a general power outlet (GPO). Turn it on and wait for the LED light to turn purple flashing (means gateway is in AP mode)
2. Turn on the WLAN of the iPhone and connect to your Wi-Fi router

Tips: If the gateway LED indicator light is not in purple flashing status, please reset it to factory settings follow the user guide of the gateway SEG-X3.

Chapter 2 Mobile App installation

1. Tap the "App Store" icon on your home screen. The icon is blue with a white "A" at the center of a circle

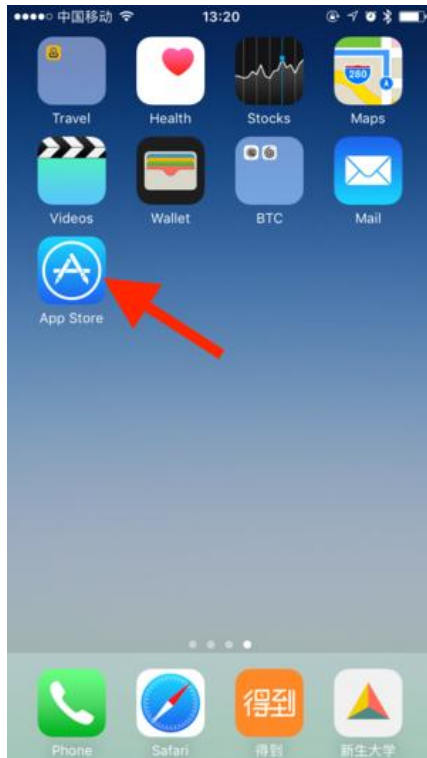

2. Tap "Search" icon at the bottom

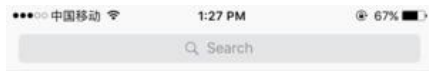

Trending

- frenzy
- hopper
- goat
- flipp
- google translate
- ticketmaster canada
- qr code scanner
- sephora canada
- kahoot
- speed test



3. Type "SmartOWON" (capitalization isn't important) into the search bar at the top

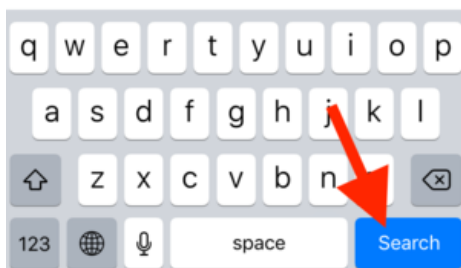
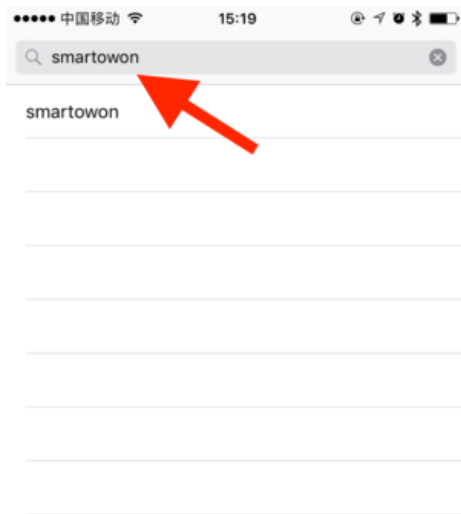

4. Tap "get" or cloud icon (if you installed this app before) to download and install

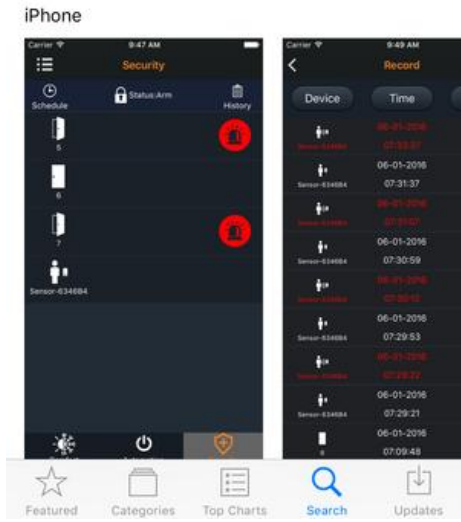
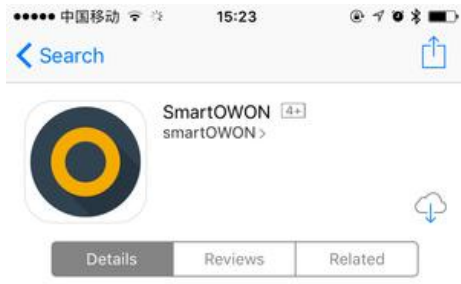

5. Finish installation, tap the "open" to open this app

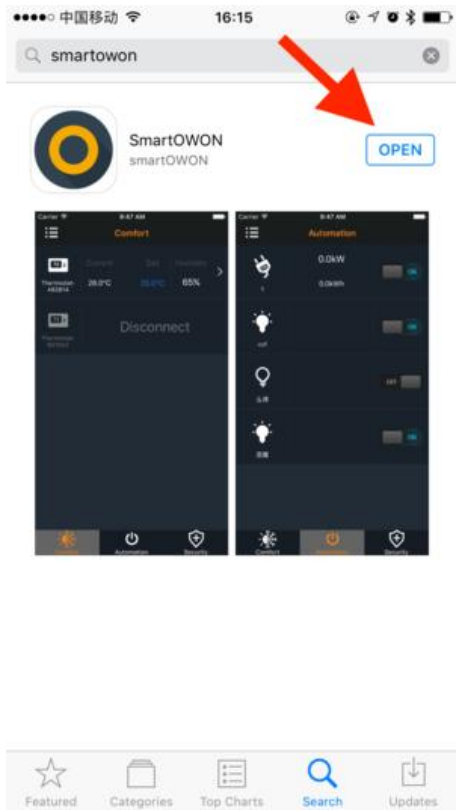

Tips: After installation, you will see the SmartOWON icon in the home screen. You could open from there also.

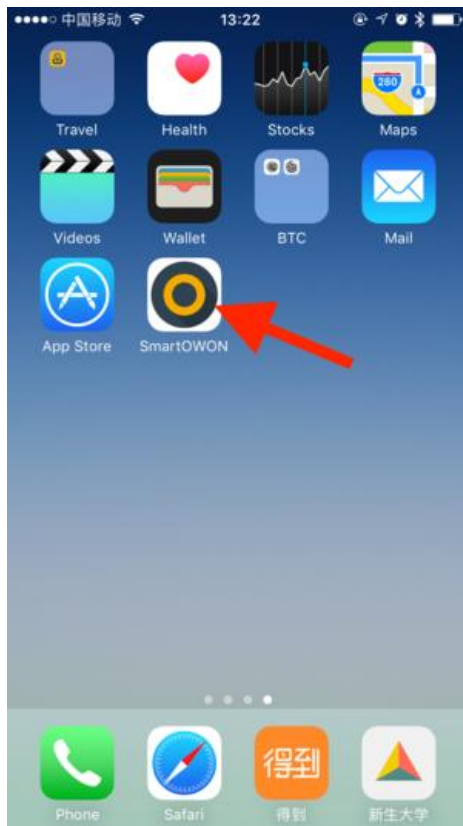

Chapter 3 Register an account

1. After installing the mobile app, open the mobile app, tap "Allow" so that you will be able to receive notifications regarding your system

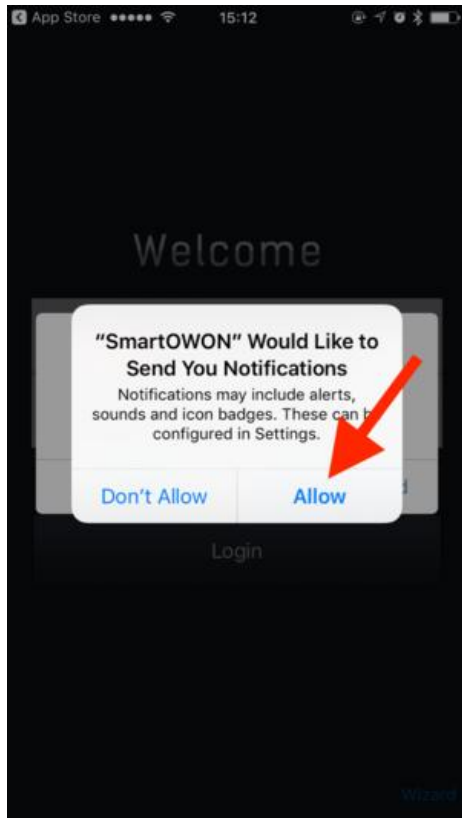

2. Then please tap "Start the wizard" to start register an account

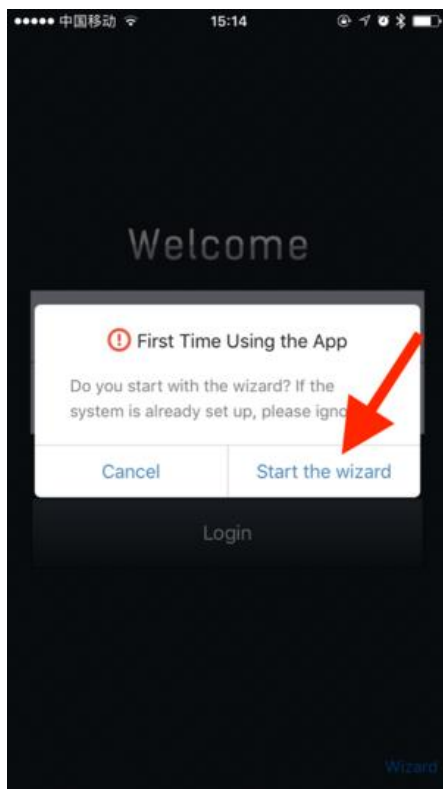

Tips: If you did not see the popup, just tap the "Configuration Wizard" in the bottom right corner.



3. Tap "Go for connecting with smart gateway"



4. (Optional) Tap "< Settings" to go to the WLAN setting interface

5. Scroll back to the WLAN interface and tap "WLAN"



6. Tap the Wi-Fi start with "ZB_GW" and end with "MAC address of the gateway" (which is the Wi-Fi hotspot of the SEG-X3 gateway), then your iPhone will connect to this Wi-Fi.

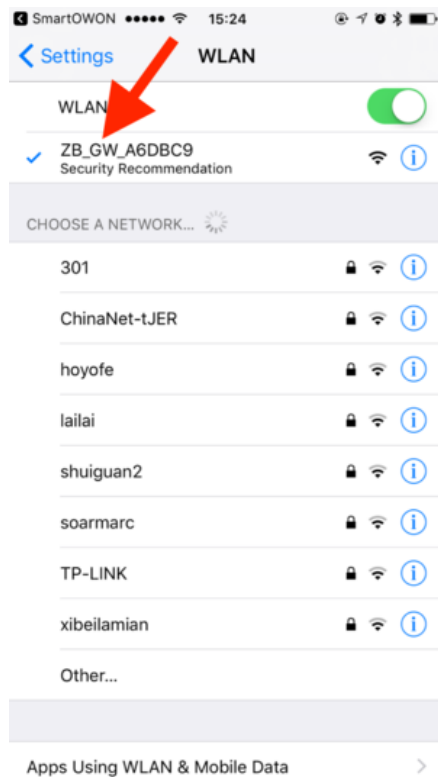

7. Tap the "SmartOWON" at the top-left corner

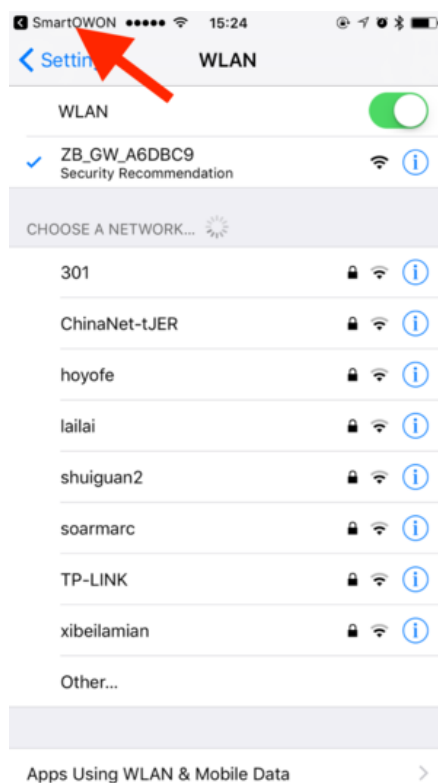

8. Type your home Wi-Fi account and password, and then tap "Go for connecting your home Wi-Fi network"



(Optional) Then you will enter, tap the "< Settings" to go to the WLAN setting interface



9. Check if the WLAN is connected to your home Wi-Fi you just used (in 8).



Tips: If not, please connect to the Wi-Fi.

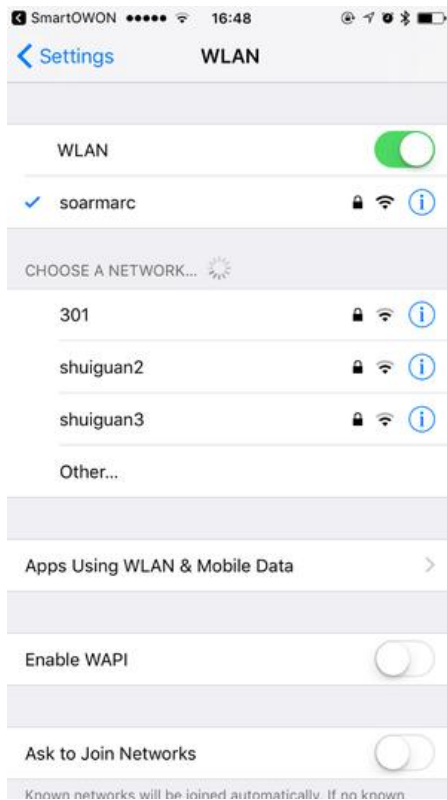

10. Tap the "SmartOWON" at the top-left corner, then you will see "connecting to your home Wi-Fi network" interface. Tap the "SmartOWON" at the top-left corner



11. "Connecting to your home Wi-Fi network" interface



12. Type the username and password, tap "create" to create a new user. When create successfully, you will login automatically

> Create a new account

The screenshot shows a mobile application interface for creating a new account. At the top, the status bar displays '中国移动' (China Mobile), the time '16:49', and various system icons. Below the status bar, the word 'Wizard' is written in orange. The main content area is titled '3 Create a new account' in green. It contains three input fields: 'Name' with the text 'marc02', 'Password' with six dots, and 'Confirm Password' with six dots. A 'Create' button is located at the bottom of the form. At the very bottom of the screen, there is a navigation bar with two options: 'Create a new account' (highlighted in orange) and 'Already have an account'.

Tips: if you have ever registered an account before, it will prompt that this gateway has been associated with an existing account that you could use to login directly.

> Login automatically



Chapter 4 Login and key interfaces introduction

Notes: The first time you login this system, since there is not any device added into this system, there will be not devices shown on those interfaces of this section

4.1 Comfort interface

Thermostats, air conditioners, temperature and humidity sensors, etc. will be shown in this interface. The App interface will be like below:



4.2 Automation interface

Smart plugs, power relays, light LED bulbs, etc. will be shown on this interface. The App interface will be like below:



4.3 Security interface

All security sensors including door/windows sensors, PIR (motion sensors), smoke detector sensors, etc. will be shown on this interface. The App interface will be like below:



4.4 Settings interface

You will be able to set "Add new devices", change password, select timezone, update the firmware via the "About" interface as well as logout. The App interface will be like below:

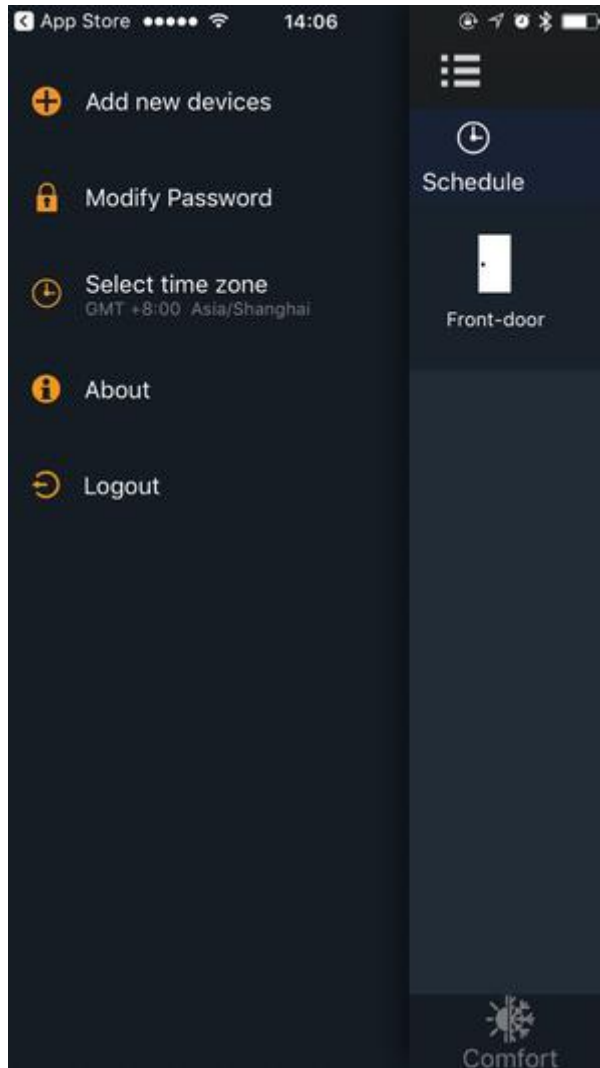

Chapter 5 Other Functions

5.1 Update gateway firmware

Step 1: Tap "About"

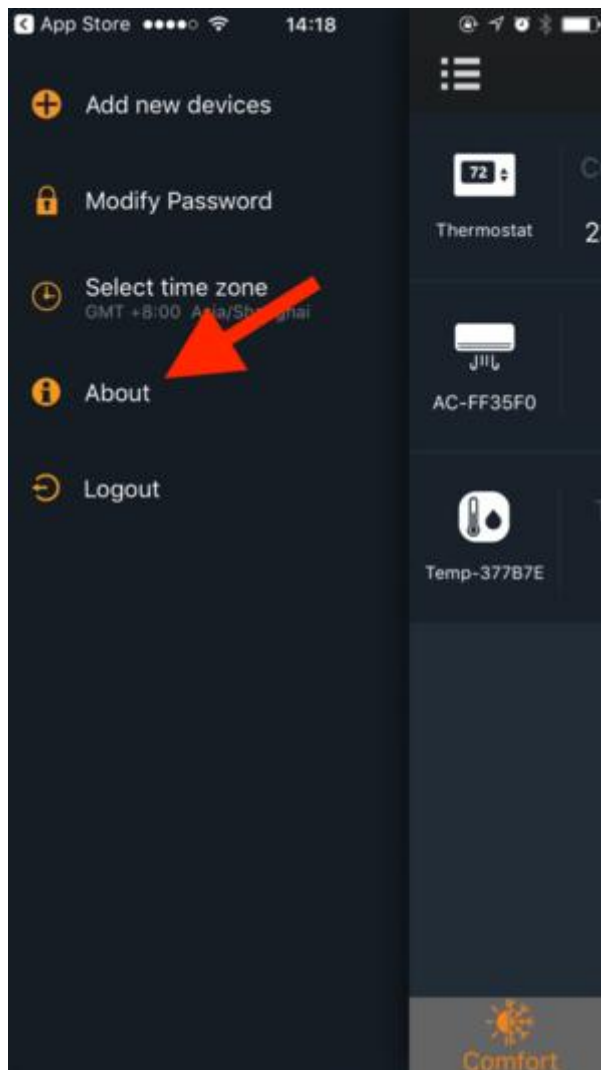

Step 2: Tap "Check Update" to see if there is an available update firmware, if so then tap the link to download and update

5.2 Change time zone

Step 1: Tap "Select time zone"

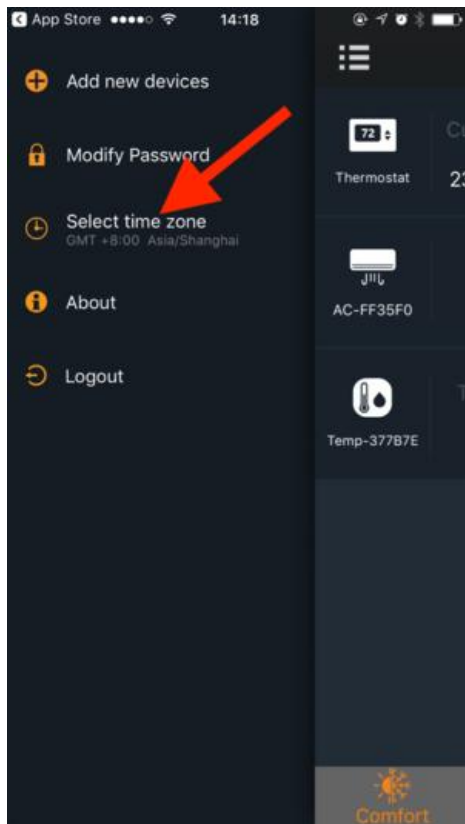

Step 2: Select your timezone and it will save.

